

Remove Students from a Class (Teacher)

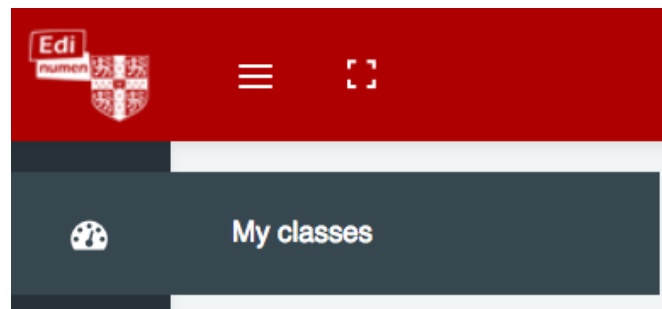





This teacher tutorial provides instructions for removing students from a class you have created in ELEteca, the learning management system for Cambridge Spanish materials.

1. To see a list of students enrolled in each of your classes, go to **My classes**:



2. Select a class and **click the unenroll from class icon** to the right of the student's name under Enrollments:

Enrollments [add teachers or students](#)

Profile	First name email	Unenroll from class
 Teacher One teacherss1@yopmail.com		Unenroll from class
 Student 11 studentss11@yopmail.com		
 Student 12 studentss12@yopmail.com		
 Student 13 studentss13@yopmail.com		

3. If you are sure that this student shouldn't be in your class anymore, **click OK** in the pop-up window that appears:

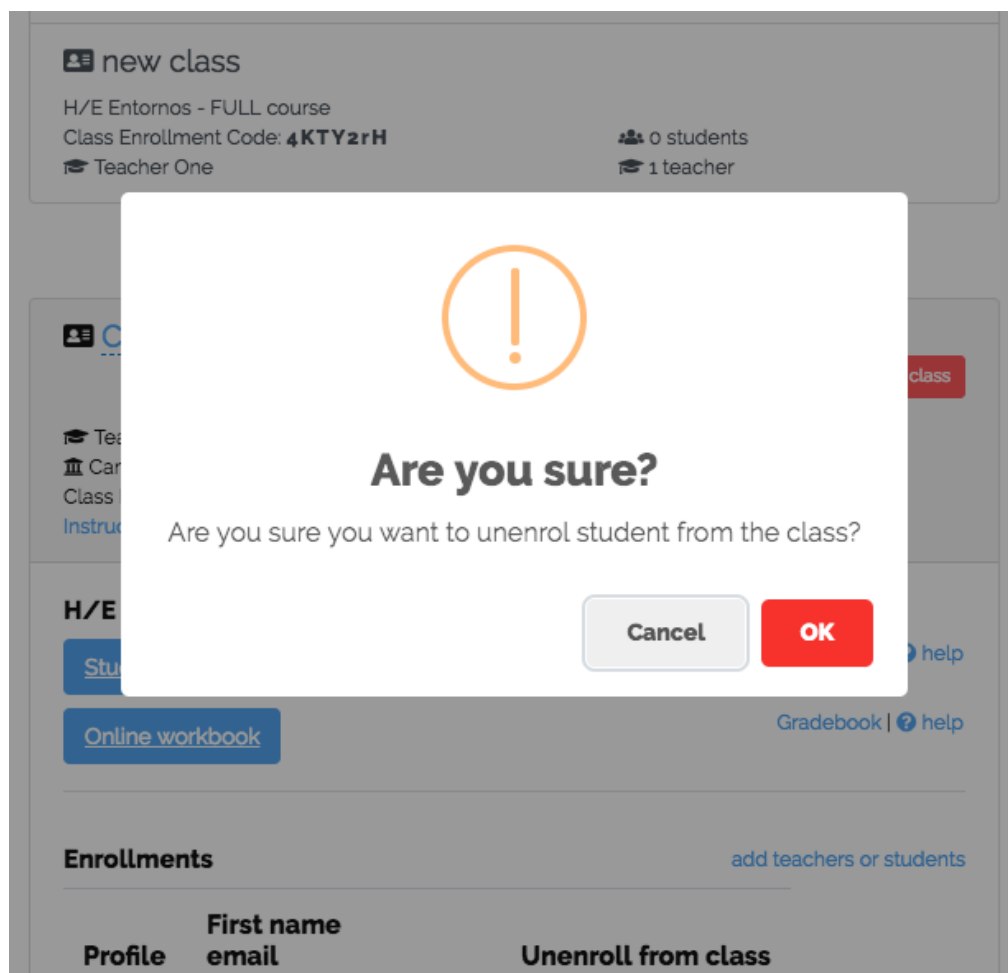

Questions about....

Need additional help? Please go to <https://edinen.es/ele-help>

Scheduling a Training? To schedule a training, please fill out this [form](https://goo.gl/forms/ngo2G5mDRWeaB9c93) (<https://goo.gl/forms/ngo2G5mDRWeaB9c93>)

Authentic resources? Please visit the Pinterest pages for Cambridge Spanish: www.pinterest.com/cambridgeesp

Other questions? Contact your [K-12 Language Specialist](http://www.cambridge.org/gb/education/find-your-sales-consultant/united-states) (<http://www.cambridge.org/gb/education/find-your-sales-consultant/united-states>) or your [Higher Ed Language Specialist](http://www.cambridge.org/gb/cambridgeenglish/contact/united-states?contact-type=Sales+Representative#contact-data) (<http://www.cambridge.org/gb/cambridgeenglish/contact/united-states?contact-type=Sales+Representative#contact-data>)